

Structural Support

MOST

L.C. Smith College of
Engineering and Computer Science
at Syracuse University*

Thanks to Our Sponsors

Lockheed Martin MS2
American Society of Civil Engineers
Technology Alliance of CNY
C&S Companies
Barton & Loguidice
American Council of Engineering
Companies - New York Central Region
Plumley Engineering

With Special Thanks To

Byrne Dairy for Beverages
Harrison Bakery for Doughnuts
Visual Technologies for AV Support

Build'em and Bust'em Committee

Kevin Barnett	Jeremy McCarthy
Diane Darwish	Toni Paglia
Christine Hains	Chris Perrine
Howie Hollander	Peter Plumley
Tom Horth	Justin Sawyers
Kevin Lucas	Lauren Seelbach

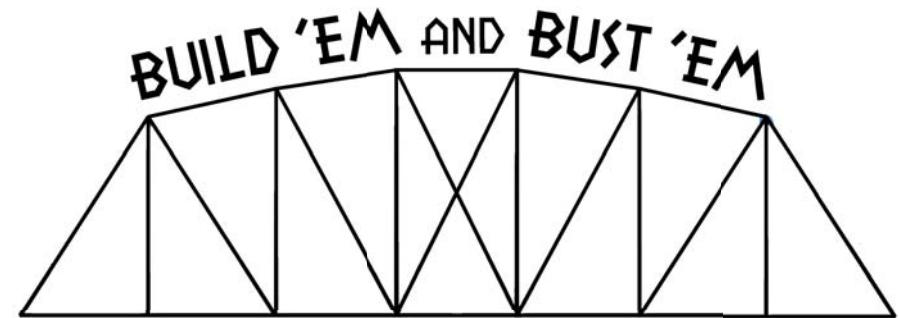

BRIDGE BUILDING CONTEST

Saturday, November 21, 2009
8:30 a.m. to 1:00 p.m.

*Be sure to visit the L.C. Smith College of Engineering
and Computer Science Information Table in the MOST Lobby.

MOST*

Milton J. Rubenstein
Museum of Science & Technology
Armory Square, Downtown Syracuse

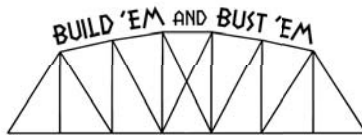

Awards Ceremony 11:45 a.m. - Mezzanine Level

Bridge Competition Awards

Category 1 Grades 4-6

Build 'em and Bust 'em Winning Bridges (1st, 2nd, 3rd & 4th)
Best Bridge Design

Category 2 Grades 7-8

Build 'em and Bust 'em Winning Bridges (1st, 2nd, 3rd & 4th)
Best Bridge Design

Category 3 Grades 9-12

Build 'em and Bust 'em Winning Bridges (1st, 2nd, 3rd & 4th)
Best Bridge Design

Crane Competition Awards

Category 3 Grades 9-12

Strongest Crane- Load Capacity
Best Crane Design

**Final results will be posted at:
www.most.org/bridges**

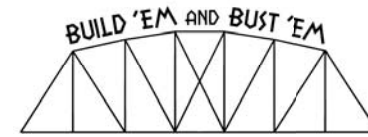

Schedule of Events

- 8:30 a.m. Coffee, Cider & Doughnuts
Phase One
- 8:30 a.m. Registration
Mezzanine/Upper Level
- 9:20 a.m. Welcoming Remarks
Peter Plumley, MOST Exhibit Projects Manager
- 9:30 a.m. **Bust 'em!**
Mezzanine/Upper Level
- 11:15 a.m. Pizza Lunch
Phase Two & Mezzanine/Upper Level
- 11:45 a.m. Awards Ceremony
Mezzanine/Upper Level
Larry Leatherman, MOST President
Prof. Can Isik, Associate Dean, College of
Engineering and Computer Science, SU
Prof. Laura J. Steinberg, Dean, College of
Engineering and Computer Science, SU

Additional Opportunities

- All Day MOST Exhibits
Open to students, families and teachers
- 9:00 a.m. Amateur Radio Telecommunications Lab
Open until 1 p.m.
- 9:45 a.m. Pythons, Bubbles & Motion
Demonstration Stage
- 10:00 a.m. IMAX® Movie *The Dream is Alive*
Bristol IMAX Omnitheater
Cost: \$6
- 10:15 a.m. Coral Reef Lifeforms
Coral Reef Tank, Earth Science Discovery Cave
- 10:45 a.m. Liquid Nitrogen and Elephant's Toothpaste
Demonstration Stage